

THIS DOCUMENT IS THE PROPERTY OF  
KEYSTONE ELECTRONICS CORP. AND  
SHALL NOT BE REPRODUCED, DISTRIBUTED  
OR USED AS A BASIS FOR MANUFACTURE  
WITHOUT PRIOR WRITTEN PERMISSION  
FROM KEYSTONE ELECTRONICS CORP.

ACTUAL SIZE

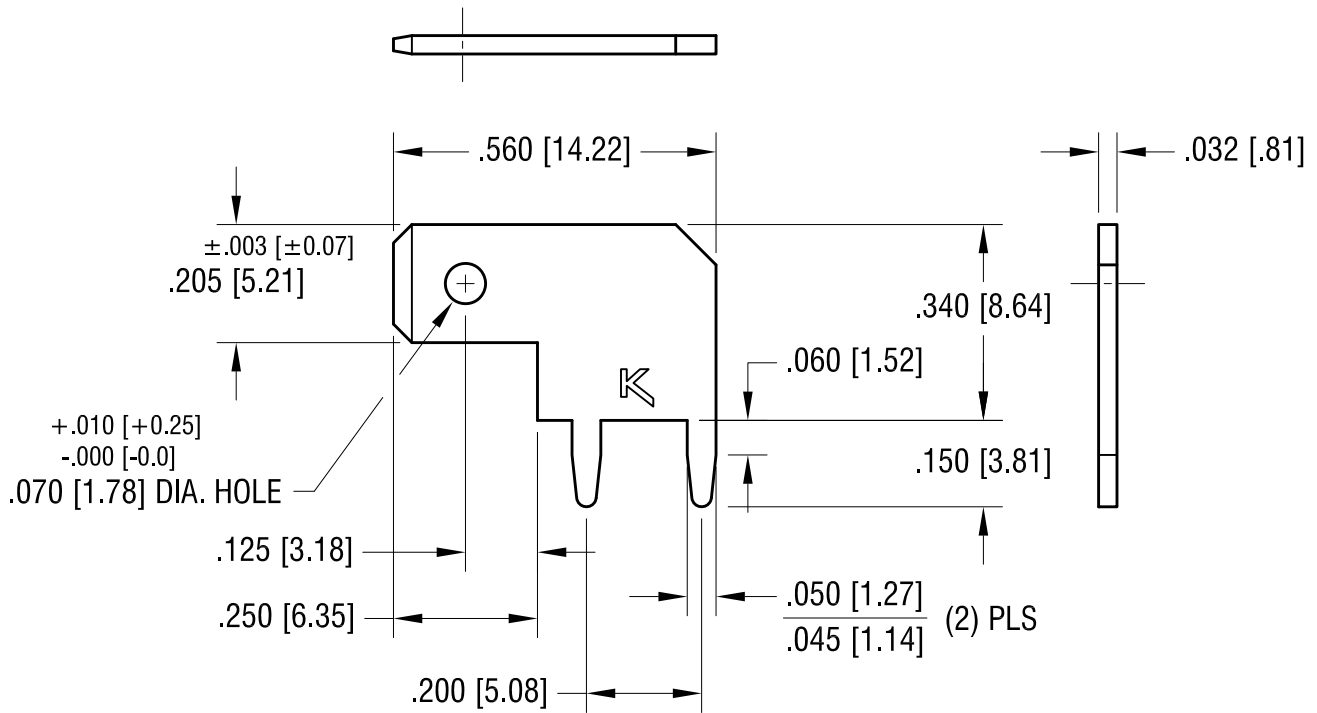
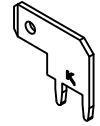

**NOTE:**

MOUNTING HOLE SIZE:  
.052 [1.32] DIA.

**KEYSTONE ELECTRONICS CORP.**

www.keyelco.com • ASTORIA, N.Y. 11105-2017 • Tel (718) 956-8900

PART NAME

.205 [5.21] PC QUICK-FIT TERMINAL

MATERIAL

.032 [0.81] TH'K BRASS

FINISH

MATTE TIN PLATE

DRN BY

BOONE

DATE

6.14.05

APP'D

LN

SCALE

3X

TOLERANCES

INCH [MM]  
DECIMAL ± .005 [± 0.15 ]

CODE

ANGULAR ± 1°  
UNLESS OTHERWISE SPECIFIED

C

DWG NO.

**4909**

9.15.15	CHANGE AS PER ECN 15-093	B
6.10.09	CHANGE AS PER ECN 09-063	A
DATE	DESCRIPTION	REV.